

| | | | | | |
|-----|-----------------|---------------|-----|--------------------|--|
| 25 | KX06-198E-19A | Gland Nut | 1 | CZ121 | |
| 24 | KX06-045B-105 | Lock &Key | 1 | | |
| 23 | KX06-009N-09-01 | Leather chain | 1 | leather | |
| 22 | KX06-198A-52 | Cover | 1 | CZ121 | |
| 21 | KX06-198A-81 | Gland Nut | 1 | CZ122 | |
| 20 | KX06-198A-43-S | Lug pull | 1 | CZ122 | |
| 19 | KX06-198A-80 | Release bolt | 1 | CZ122 | |
| 18 | KX06-009-24 | Pin | 2 | SS304 | |
| 17 | KX08-087-11 | Spring | 1 | SS304 | |
| 16 | KX08-021-34 | Nut | 1 | BS-1C22 | |
| 15 | KX08-201A-37 | Seal | 1 | Natural rubber | |
| 14 | KX06-032-09 | Chain | 1 | SS304 | |
| 13 | KX08-024B2-78 | cap | 1 | LM25 | |
| 12 | KX06-009-43 | Handwheel | 1 | GRAY CAST IRON 180 | |
| 11 | KX06-009E-20B | Washer | 1 | 6063 | |
| 10 | KX06-198E-10 | O-ring | 2 | NBR | |
| 9 | KX06-198F-74 | Bonnet | 1 | CZ122 | |
| 8 | KX06-174-10 | O-ring | 1 | NBR | |
| 7 | KX06-198E-02-04 | Stem | 1 | CZ121 | |
| 6 | KX06-198E-19 | Gland Nut | 1 | CZ122 | |
| 5 | KX06-198E-39 | Disk | 1 | CZ122 | |
| 4 | KX06-060-37 | DISK FACING | 1 | NBR | |
| 3 | KX06-060-20 | Spacer | 1 | 304 | |
| 2 | KX06-009-34B | Locknut | 2 | 304 | |
| 1 | KX06-198F-01 | Body & outlet | 1 | LG2 | |
| NO. | PART NO. | PART NAME | QTY | MATERIAL | |

- Technical requirements:
1. the product according to BS 5041-1:1987 design.
 2. The landing valves are suitable for continuous use at 15bar pressure rating throughout temp range from 0℃to 38℃
 3. Seal test: the test pressure 16.5bar, the test medium:water,holding pressure 2 minutes.
 4. Body strength test: the test pressure 22.5bar, the test medium:water,holding pressure 2 minutes
 5. Water flow rate test: Control valves to give a flow rate of 8.5L/min, Out pressure≥4bar when inlet pressure 4.7bar.
 6. The number of turns 4~10
 7. Body thickness≥3mm
 8. All o-rings, washers are hansheng procurement.
 9. Fully red painting of body & bonnet surface (RAL3000)

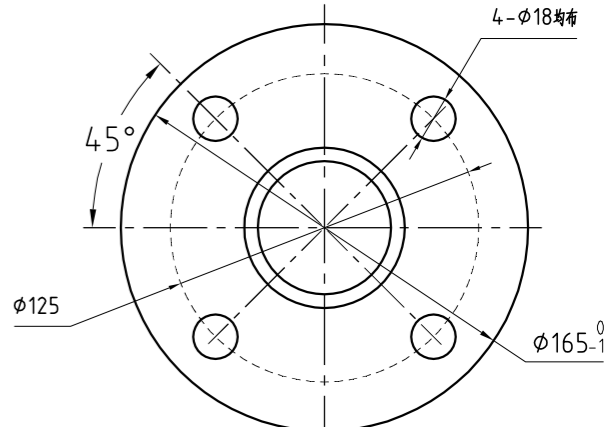

| MARKING | QTY | FRLE NO | NAMES | DATES | OBLIQUE LANDING VALVE | MATERIAL | QTY | 1 | |
|----------|-------|---------|------------|-------|-----------------------|----------|-----------------|--------|-------|
| INITIAL | NAMES | | DATES | | | | DRAWING MARKING | WEIGHT | SCALE |
| DESIGNED | | | | | | | D | 6.53Kg | 1:1.5 |
| CHECKED | | | | | | | | | |
| APPROVED | | | 2019.07.01 | | | | | | |